

QUICK RESPONSE FOAM UNIT 4 x 55

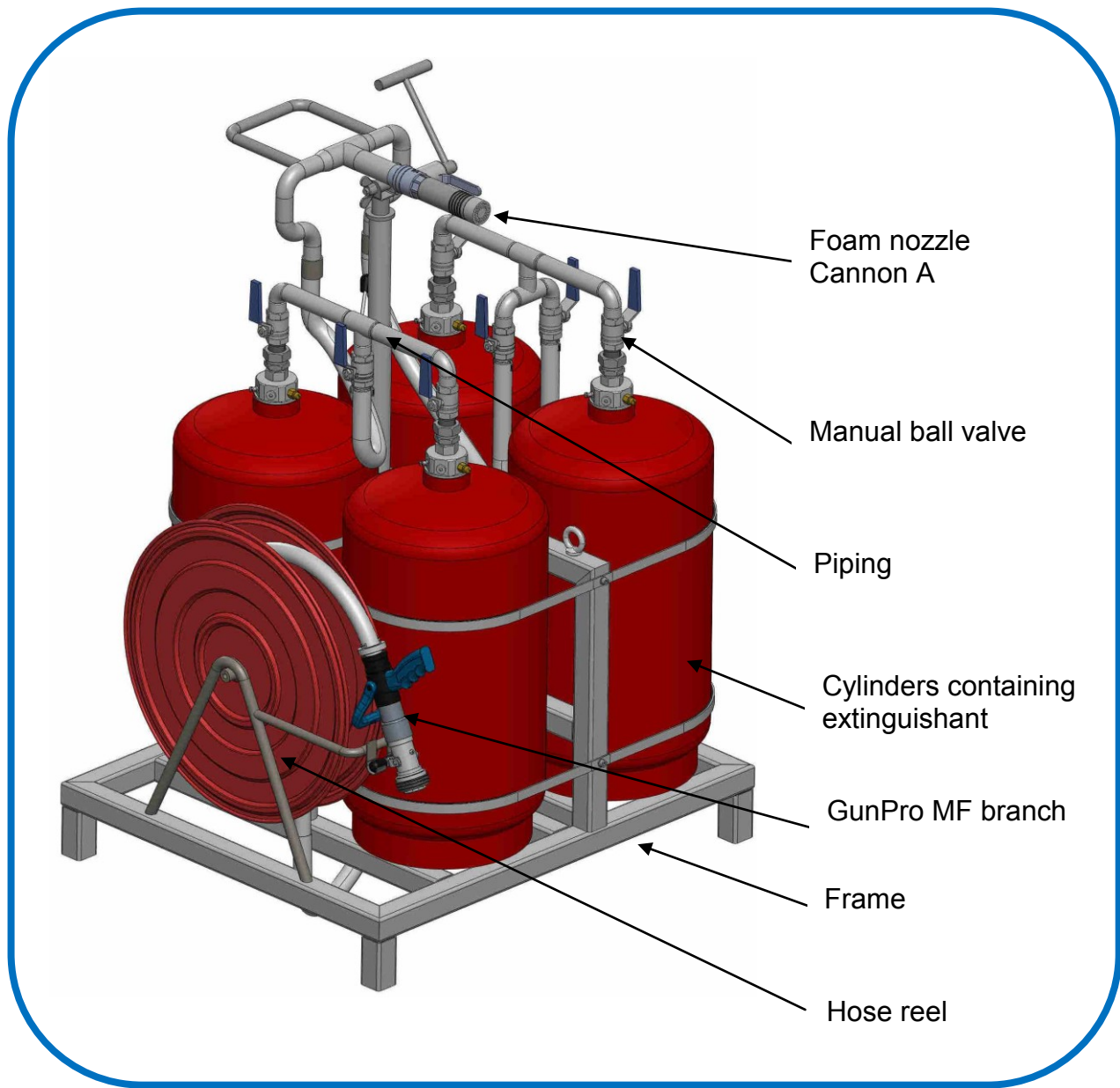

System type:



STREAM TYPES

Firm jet of foam from Cannon A.

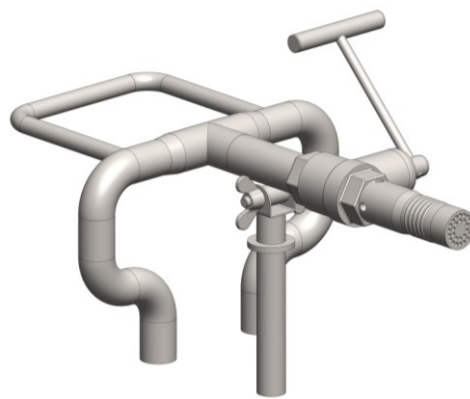

Firm jet of foam from GunPro MF.



Stream of mist from GunPro MF.

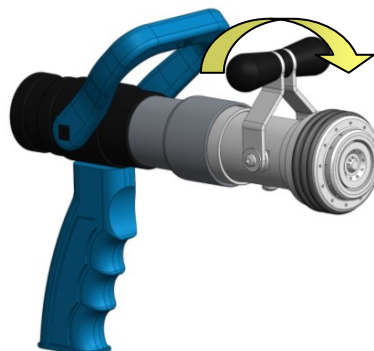

The Quick Response Foam Unit is an independent mobile extinguishing device. The versatility of the unit lies in the fact that it can extinguish flames with the large foam cannon from up to 30 m or with a branch mounted on a hose, with either firm jet or wide mist stream.

It is possible to use only some of the cylinders for extinguishing (from 1 to all 4), when the fire is not fierce enough to use up all the extinguishant or it is required to prolong the extinguishing action. The unit can be easily mounted on a car or mobile platform, which provides mobility and responsiveness.

The Quick Response Foam Unit does not require any startup time and is ready for extinguishing immediately after opening ball valves at the cylinders.

TECHNICAL DATA

Extinguishant	Water + 1% Telesolv foam
Extinguishant weight [kg]	4 x 55 (220)
Propellant	Air or nitrogen
Working pressure at temp. 20°C [bar]	15 +1
Working temperature [°C]	+5 do +60
Weight without extinguishant [kg]	170
Dimensions: width x depth x height [m]	1,5 x 1,0 x 0,85
Hose length [m]	20

Stream parameters

Branch type	Parameters	Number of connected cylinders			
		1	2	3	4
Cannon	Max. range [m]	-	26	29	31
	Working duration [s]	-	75	90	100
Gun Pro branch – foam mode	Max. range [m]	17	18	19	20
	Working duration [s]	90	130	180	240
Gun Pro branch – mist mode	Max. range [m]	5	6	8	9
	Working duration [s]	210	300	420	500
	Stream diameter [m]	1,3	1,4	1,5	1,5

Our products are constantly being developed and improved, therefore we reserve the right to change the technical specifications without prior notice.